

Peek & Play Turtle



VTech understands that a child's needs and abilities change as they grow and with that in mind we develop our toys to teach and entertain at just the right level...

vtech Baby

Toys that will stimulate their interest in different textures, sounds and colours

I am...

...responding to colours, sounds and textures

...understanding cause and effect

...learning to touch, reach, grasp, sit-up, crawl and toddle

Birth-36 months



Pre-School

Interactive toys to develop their imagination and encourage language development

I want...

...to get ready for school by starting to learn the alphabet and counting

...my learning to be as fun, easy and exciting as can be

...to show my creativity with drawing and music so my whole brain develops

3-6 years



Electronic Learning Computers

Cool, aspirational and inspiring computers for curriculum related learning

I need...

...challenging activities that can keep pace with my growing mind

...intelligent technology that adapts to my level of learning

...National Curriculum based content to support what I'm learning at school

4-10 years



To learn more about this and other VTech® products, visit www.vtech.co.uk

INTRODUCTION

Thank you for purchasing the **Peek & Play Turtle** by **VTech®**. This cute soft toy converts from a turtle to a ball. The large light up button on the turtle's shell introduces colours and numbers and plays sing-along songs and melodies. Wiggle the turtle to trigger the motion sensor to hear a variety of playful sounds. The electronic module can easily be removed to surface wash the turtle.

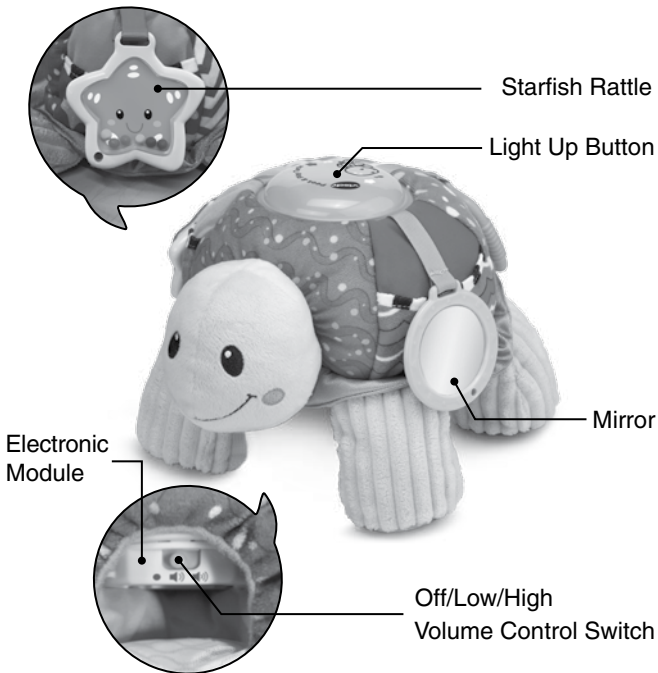

INCLUDED IN THIS PACKAGE

- One Peek & Play Turtle
- One parent's guide

WARNING: All packing materials such as tape, plastic sheets, packaging locks, removable tags, cable ties and packaging screws are not part of this toy and should be discarded for your child's safety.

NOTE: Please keep this parent's guide as it contains important information.

Please cut the plastic loop between the turtle's head and the shell and remove the cardboard piece from inside the turtle.

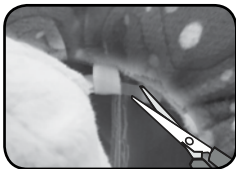

GETTING STARTED

BATTERY INSTALLATION

1. Make sure the unit is turned **OFF**.
2. Locate the battery cover on the electronic module inside the turtle. Use a screwdriver to loosen the screws.
3. Install 2 new AAA (AM-4/LR03) batteries following the diagram inside the battery box. (The use of new alkaline batteries is recommended for maximum performance).
4. Replace the battery cover and tighten the screws to secure.

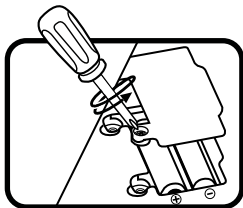

BATTERY NOTICE

- Use new alkaline batteries or fully charged NI-MH (Nickel Metal-hydride) rechargeable batteries for best performance.
- Use only batteries of the same or equivalent type as recommended.
- Do not mix different types of batteries: alkaline, standard (carbon-zinc) or rechargeable (Ni-Cd, Ni-MH), or new and used batteries.
- Do not use damaged batteries.
- Insert batteries with the correct polarity.
- Do not short-circuit the battery terminals.
- Remove exhausted batteries from the toy.
- Remove batteries during long periods of non-use.
- Do not dispose of batteries in fire.
- Do not charge non-rechargeable batteries.
- Remove rechargeable batteries from the toy before charging (if removable).
- Rechargeable batteries are only to be charged under adult supervision.

Disposal of batteries and product



The crossed-out wheellie bin symbols on products and batteries, or on their respective packaging, indicates they must not be disposed of in domestic waste as they contain substances that can be damaging to the environment and human health.



The chemical symbols Hg, Cd or Pb, where marked, indicate that the battery contains more than the specified value of mercury (Hg), cadmium (Cd) or lead (Pb) set out in Battery Directive (2006/66/EC).

The solid bar indicates that the product was placed on the market after 13th August, 2005.

Help protect the environment by disposing of your product or batteries responsibly.

For more information, please visit:

www.recycle-more.co.uk

www.recyclenow.com

ASSEMBLY INSTRUCTIONS

With the **Peek & Play Turtle**, safety comes first. To ensure your child's safety, adult assembly is required.



Electronic Module

1. To remove the electronic module from inside the turtle, make sure that the turtle's head is in the outward position. Locate the electronic module inside the main body. Pull down on the electronic module to detach it from the holder.
2. To reinsert the electronic module, please align the small blue button on the back of the electronic module with the slot on the holder inside the turtle's shell. Push the electronic module to the holder inside the shell. When the electronic module is inserted correctly, you will hear it click into place.



PRODUCT FEATURES

1. Off/Low/High Volume Control Switch

To turn the unit **ON**, slide the **Off/Low/High Volume Control Switch** to the **Low Volume** () or **High Volume** () position. You will hear a song, a phrase and a short tune. To turn the unit **OFF**, slide the **Off/Low/High Volume Control Switch** to the **OFF** () position.

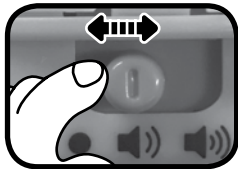

2. Automatic Shut Off

To preserve battery life, the **Peek & Play Turtle** will automatically shut off after approximately 2 minutes without input. The unit can be turned on again by pressing the **Light Up Button**.

NOTE: If the turtle repeatedly powers down when playing, we recommend changing the batteries.

The turtle is in try-me mode in the package. To access the regular play mode, please turn the unit off and then on again.

ACTIVITIES

1. Light Up Button

Press the **Light Up Button** to hear about colours and numbers and listen to songs, playful sounds and melodies.



2. Motion Sensor

Wiggle, roll or shake the turtle to activate the **Motion Sensor** and hear a variety of playful sounds and short tunes. If a melody is playing, activate the **Motion Sensor** to hear fun sounds play over the melody.

SING-ALONG SONG LYRICS

SONG 1

I'm a soft turtle,

Tuck me in and I can roll.

I'm not too big, but I'm not too small,

I'm just the right size for you to hold.

SONG 2

I'm a turtle, I'm a turtle,
I move slow, I move slow.
Turn me into a ball, turn me into a ball,
I will roll, I will roll.

SONG 3

Hi little baby, explore with me.
Let's go on a crawling journey.
Follow my steps now 1-2-3,
There's so much for us to see.

SONG 4

Crawling, rolling, playing with you.
Hiding, seeking, peek-a-boo.
Red and yellow, and green and blue,
I'm peeking out of my shell to play with you!

MELODY LIST

1. Take Me Out to the Ball Game
2. The Teddy Bears' Picnic
3. Yankee Doodle
4. Boys and Girls Go Out to Play
5. Goosey Goosey Gander
6. Camptown Races
7. The Mexican Hat Dance
8. On Top of Old Smokey

9. One Man Went to Mow a Meadow
10. Peter, Peter Pumpkin Eater
11. She'll Be Coming 'Round the Mountain
12. Where Has My Little Dog Gone?
13. When the Saints Go Marching In
14. Turkey in the Straw
15. Froggie Went A-Courting

CARE & MAINTENANCE

1. Keep the unit clean by wiping it with a slightly damp cloth.
2. Keep the unit out of direct sunlight and away from any direct heat sources.
3. Remove the batteries when the unit is not in use for an extended period of time.
4. Do not drop the unit on a hard surface and do not expose the unit to excess moisture.
5. The **Peek & Play Turtle** is surface washable only.

TROUBLESHOOTING

If for some reason the program/activity stops working, please follow these steps:

1. Turn the unit **OFF**.
2. Interrupt the power supply by removing the batteries.
3. Let the unit stand for a few minutes, then replace the batteries.
4. Turn the unit back **ON**. The unit will now be ready to play again.
5. If the unit still does not work, replace with an entire set of new batteries.

If the problem persists, please call our Consumer Services Department 03306780149 (from UK) or + 44 3306780149 (outside UK) and a service representative will be happy to help you.

IMPORTANT NOTE:

Creating and developing **VTech®** products is accompanied by a responsibility that we at **VTech®** take very seriously. We make every effort to ensure the accuracy of the information, which forms the value of our products. However, errors sometimes can occur. It is important for you to know that we stand behind our products and encourage you to call our Consumer Services Department on 03306780149 (from UK) or + 44 3306780149 (outside UK), or by going to our website at www.vtech.co.uk and filling out our Contact Us form located under the Customer Support link with any problems and/or suggestions that you might have. A service representative will be happy to help you.

**CLASS 1
LED PRODUCT**



PRODUCT REGISTRATION

Visit www.vtech.co.uk/clubvtech/login
to register your VTech product

By joining the VTech Club you can also enter competitions, find out about news and events, seek expert advice for parents and let your kids play fun learning games and activities.



PRODUCT WARRANTY

Thank you for choosing this quality product from VTech. We hope it will bring many hours of entertainment, imaginative play and learning.

1. The product detailed above is covered by a one year warranty from the date of purchase, against any defects in materials or workmanship.
2. The product may be returned to the place of purchase. Alternatively the product can be returned to VTech Electronics Europe plc (see address below), with proof of purchase, without proof of purchase no replacement will be provided.
3. VTech Electronics Europe plc will examine the product and if it is found to be defective due to faulty materials or workmanship, will replace the product at their discretion.
4. If the product covered by this warranty is damaged due to misuse, modification or unauthorised repair, or because of faulty batteries, battery discharge or incorrect electrical connections, then this warranty becomes void.
5. This warranty is personal to the original purchaser and is not transferable.
6. Breakages to the LCD screen are not covered by the warranty.
7. Returns to VTech Electronics Europe plc should include a cheque or postal order for £1.50 towards the cost of return postage and packaging.
8. Products returned to VTech Electronics Europe plc, should be addressed as follows and packed carefully to avoid damage in transit (Please do not include batteries or adaptor). Please include details of the fault together with your name and address.
9. To keep an online record of your warranty, please register your product online at www.vtech.co.uk/warranty

VTech Electronics EU PLC, c/o XPO Logistics, Warehouse 350, Cat & Fiddle Lane, West Hallam, DE7 6HE

THIS WARRANTY IS OFFERED AS AN EXTRA BENEFIT AND DOES NOT AFFECT CONSUMERS' STATUTORY RIGHTS.

This warranty is valid for the UK and Eire only. For products purchased outside the UK and Eire, please contact your local distributor or place of purchase.

**Visit our website for more
information about our products,
downloads, resources and more.**

www.vtech.co.uk

